

Enviar comandos UDS usando Car Scanner?

The image displays two screenshots of the Car Scanner Pro application. The left screenshot shows the main menu with various diagnostic tools. The right screenshot shows the Settings menu with a list of options and a version/build information section.

Car Scanner Pro Main Menu:

- Dashboard
- Live data
- All sensors
- Diagnostic trouble codes
- Freeze frame
- Noncontinuous Monitors
- ECU identifiers
- Data recording
- My cars
- Settings**
- Statistics
- Acceleration tests
- Emission tests
- Coding & Service

Settings Menu:

- Interface
- Units
- Dashboard
- Vehicle options
- Fuel consumption
- Sensors
- Give rating
- Backup
- Terminal
- Contact developer
- Info**
- Custom codings

Version and Build Information:

- Version: 1.96.4
- Build: 400964 /GP

Additional Links:

- CarScanner.Info
- Privacy policy
- Icons from Icons8

Experimental Features:

- Show experimental features

Copyright: Copyright (c) 0vZ 2016-2023

ELM connection: Disconnected
ECU connection: Disconnected

Buttons: CONNECT, Demo

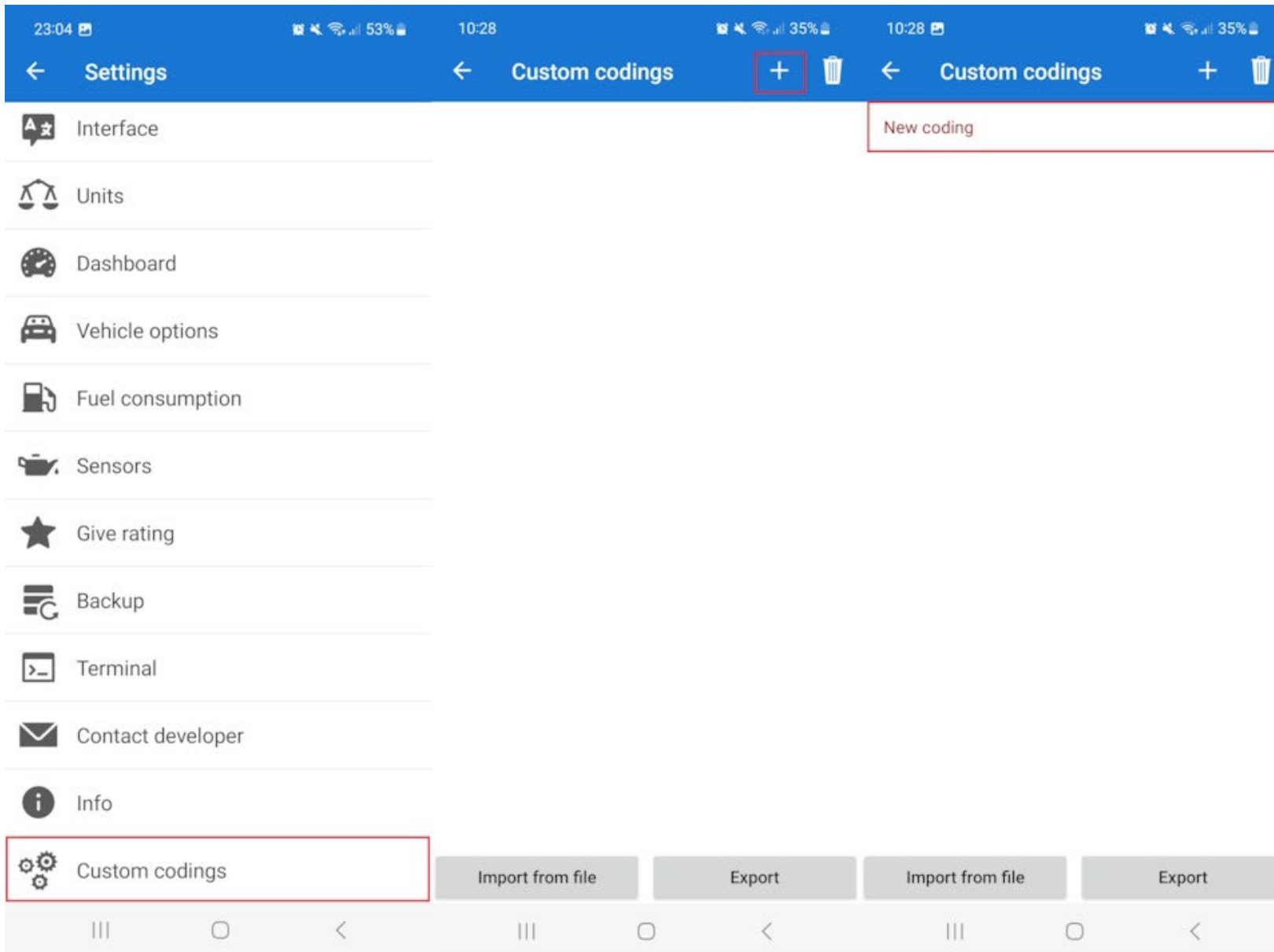

10:30 35%

← Custom coding editor

1. Description: ^

Group: 20103

Other

Name: Sport Layout

Description:

Inner description:

Comment: 104F

1.1. Translations: v

2. Address and unit: ^

Request header: 714

Response header: 77E

Extended address:

10:33 34%

← Custom coding editor

Password: 20103

Password hint: 20103

Read mode and address: 3D1403003C09

Write mode and address:

ATST (hex): 96

Protocol:

Open session command: 104F

PreRead Commands:

PreWrite Commands: 22F198;22F199;2703;2704;2EF198;2EF199;

PostWrite Commands: 1102

Make changes to initial data

10:35 34%

← Custom coding editor

PostWrite Commands: 1102

Make changes to initial data

3. Value type: ^

Options

Byte number (starting from 0): 0

New Title: New

Value:

Read only value:

Translations:

Language:

Title:

Add Del

Up Down + -



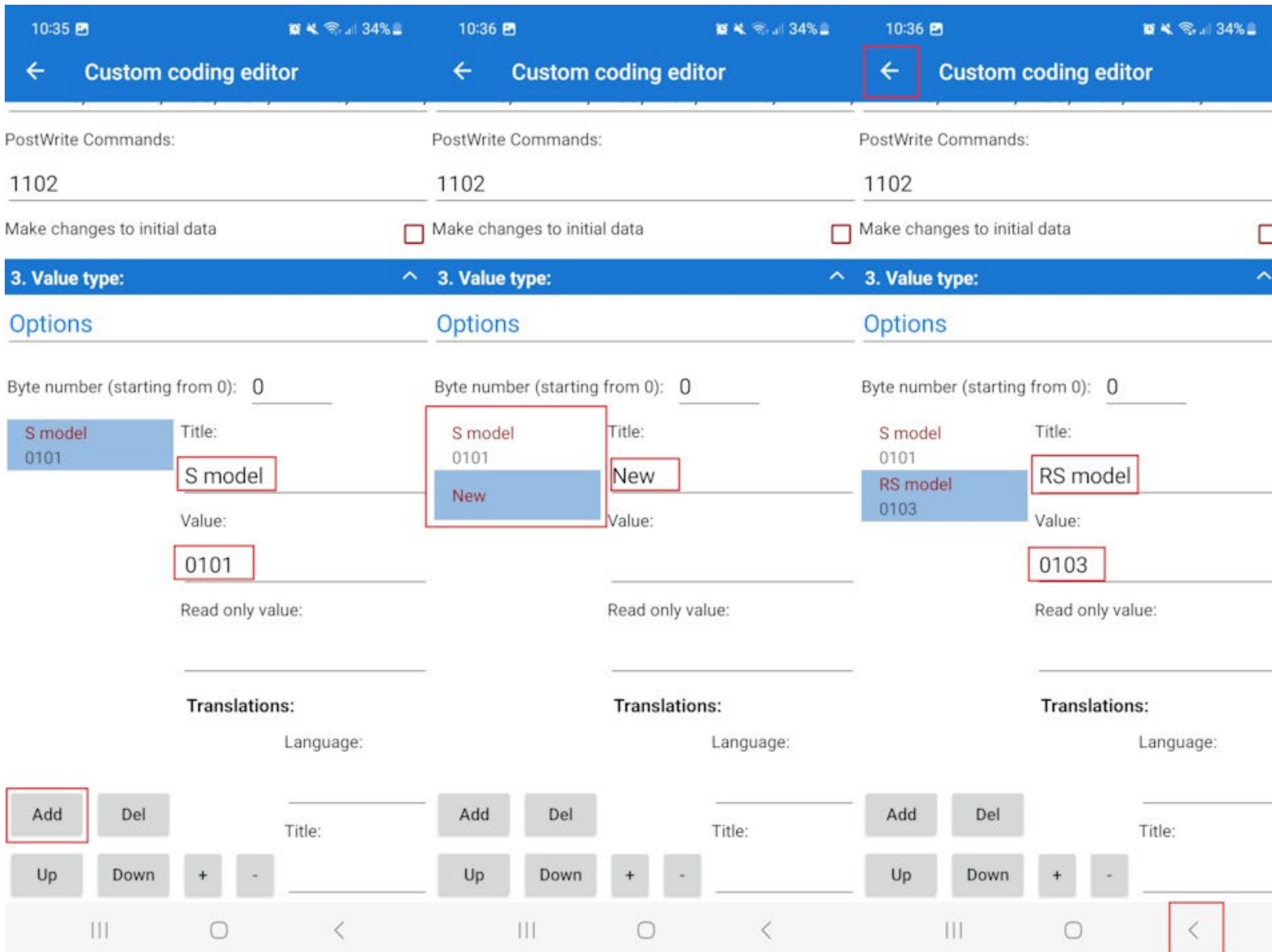

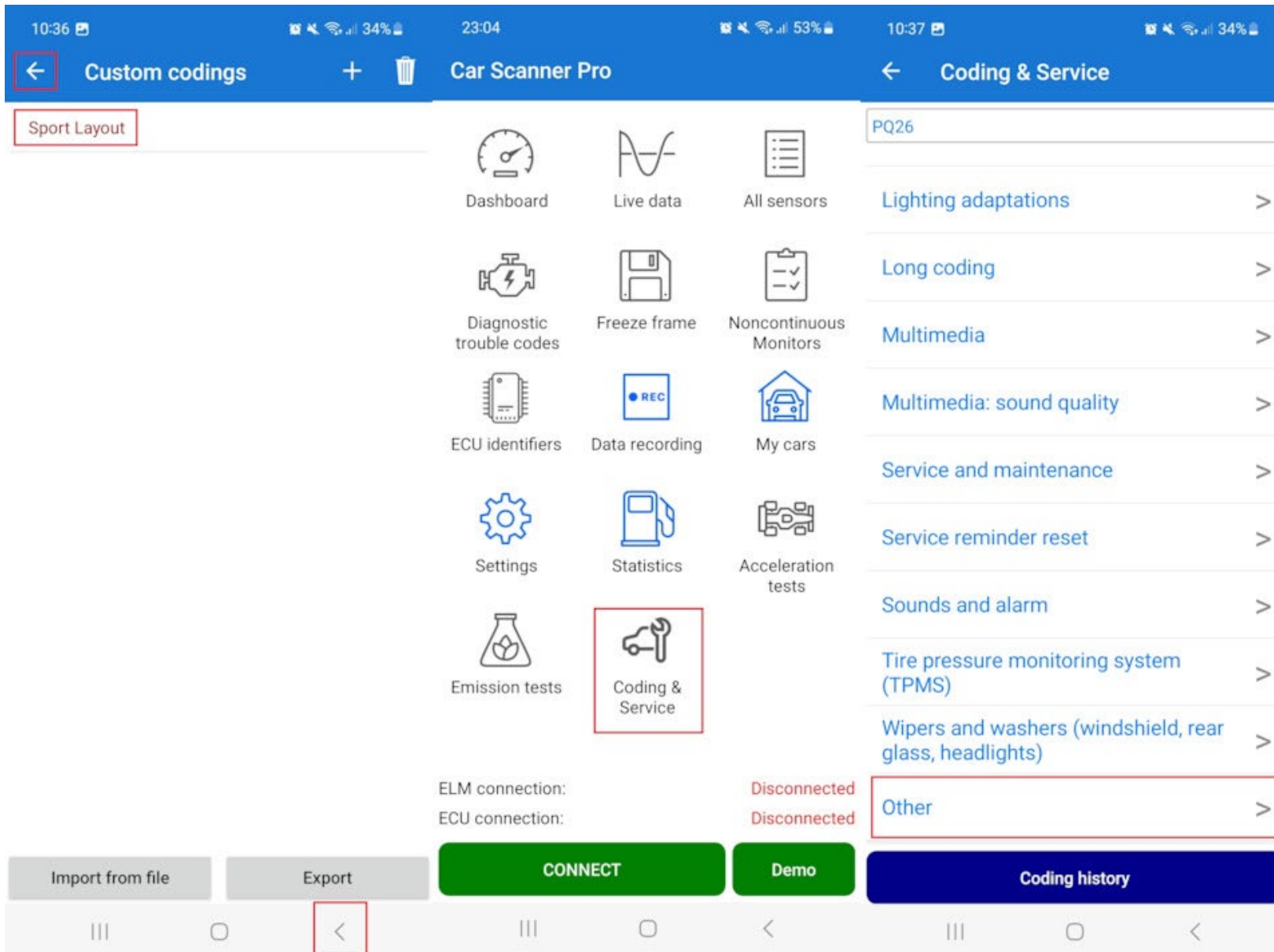

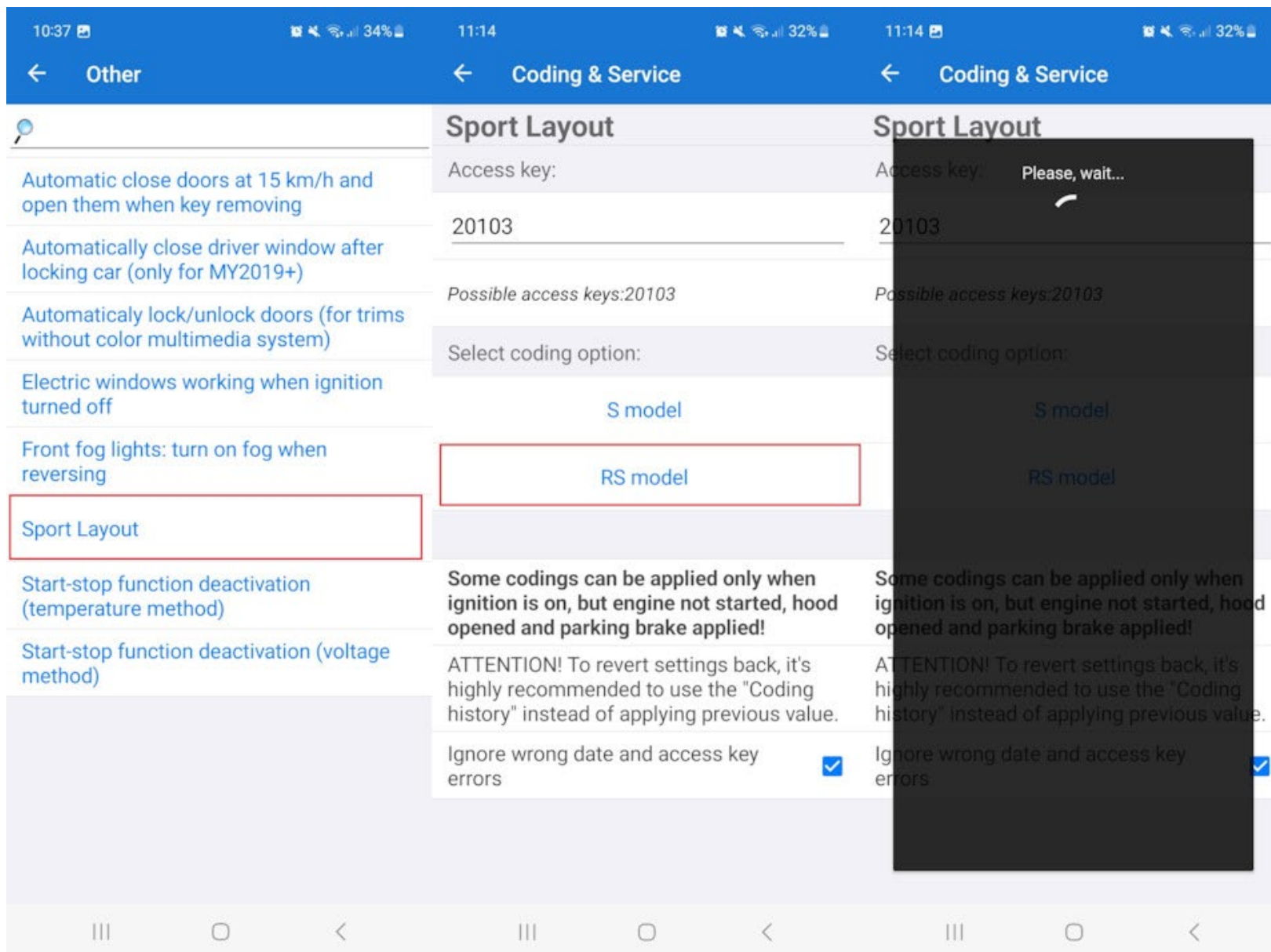

¡BUENO SABER! Con las últimas versiones de Car Scanner, ya no es necesario hacer lo anterior. Simplemente seleccione el perfil de conexión de Audi en la configuración, luego vaya a " Codificación y servicio->MQB->Dashboard->Audi Sport Layout (FPK Gen.1 / VC Gen.1) "

La historia del indicador BOOST que no funciona