

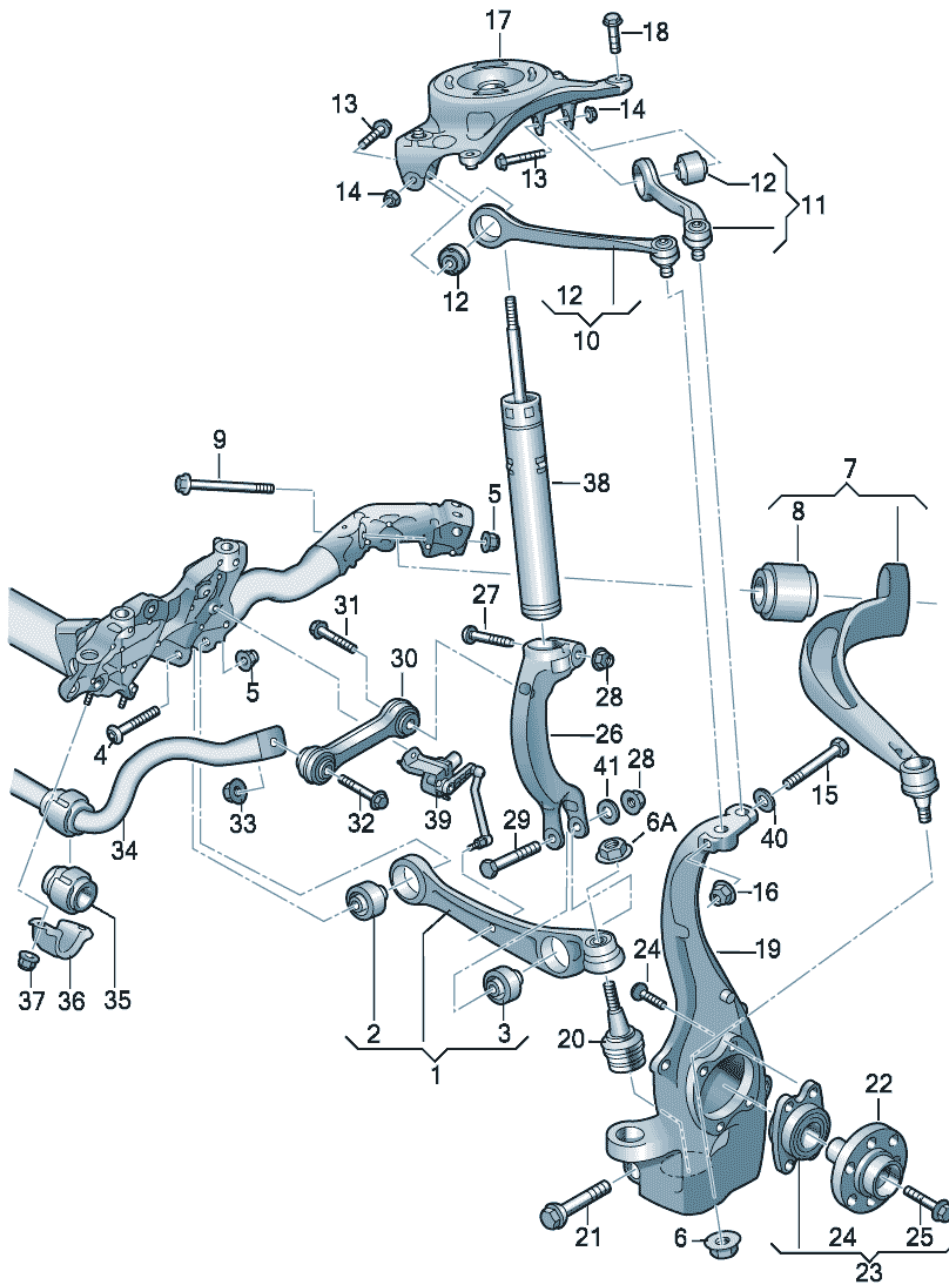

# ETKA

| Model | Year | MG | SG | Illustration | Restrictions | UPD | 22:09 | 15.08.2013 |
|-------|------|----|----|--------------|--------------|-----|-------|------------|
| AQ5   | 2013 | 4  | 07 | 407-00       |              | 978 |       |            |





# ETKA

|       |      |    |    |              |              |     |       |            |
|-------|------|----|----|--------------|--------------|-----|-------|------------|
| Model | Year | MG | SG | Illustration | Restrictions | UPD | 22:09 | 15.08.2013 |
| AQ5   | 2013 | 4  | 07 | 407-00       |              | 978 |       |            |

| Pos  | Part Number   | Description   | Remark            | Qty | Model  |
|------|---------------|---|-------------------|-----|--------|
|      |               | front wishbone link<br>wheel bearing housing<br>anti-roll bar |                   |     | PR-0K0 |
| 1    | 8K0 407 151 F | front wishbone link   | left front        | 1   |        |
| (1)  | 8K0 407 152 F | front wishbone link   | right front       | 1   |        |
| 2    | 8K0 407 182 B | bonded rubber bush  | inner             | 2   |        |
| 3    | 4EO 407 181 B | bonded rubber bush  | outer             | 2   |        |
| 4    | WHT 001 949   | round hd. screw   | M12X1,5X92        | 2   |        |
| 5    | WHT 001 987   | hex. nut, self-locking with washer                            | M12X1,5           | 4   |        |
| 6    | WHT 006 151   | hexagon collar nut self-locking                               | M14X1,5           | 2   |        |
| 6A   | WHT 006 151   | hexagon collar nut self-locking                               | M14X1,5           | 2   |        |
| 7    | 8K0 407 693 Q | suspension guide  | left front        | 1   |        |
| (7)  | 8K0 407 694 Q | suspension guide  | right front       | 1   |        |
| 8    | 8K0 407 183 D | hydro-mounting  | inner             | 2   |        |
| 9    | N 107 315 01  | hex collared bolt   | M12X1,5X118X90    | 2   |        |
| 10   | 8K0 407 505 A | guide   | left front upper  | 1   |        |
| (10) | 8K0 407 506 A | guide   | right front upper | 1   |        |
| 11   | 8K0 407 509 A | guide   | left rear upper   | 1   |        |
| (11) | 8K0 407 510 A | guide   | right rear upper  | 1   |        |
| 12   | 8R0 407 515   | bonded rubber bush  |                   | 4   |        |
| 13   | N 104 253 02  | hex collared bolt   | M10X62X45         | 4   |        |
| 14   | N 102 861 10  | hexagon collar nut self-locking                               | M10               | 4   |        |
| 15   | N 107 709 01  | hex collared bolt   | CM10X110X24       | 2   |        |
| 16   | N 102 723 02  | hexagon collar nut self-locking                               | M10               | 2   |        |
| 17   | 8K0 412 391 F | bracket   | left              | 1   |        |
| (17) | 8K0 412 392 F | bracket   | right             | 1   |        |
| 18   | N 911 523 01  | hexagon head bolt (combi)                                     | M10X35 S22        | 8   |        |



# ETKA

|       |      |    |    |              |              |     |       |            |
|-------|------|----|----|--------------|--------------|-----|-------|------------|
| Model | Year | MG | SG | Illustration | Restrictions | UPD | 22:09 | 15.08.2013 |
| AQ5   | 2013 | 4  | 07 | 407-00       |              | 978 |       |            |

| Pos  | Part Number   | Description  | Remark  | Qty | Model        |
|------|---------------|--|---|-----|--------------|
| 19   | 4G0 407 253 A | wheel bearing housing<br>*no 'fi' function possible<br>see parts bulletin:<br>see workshop manual<br>alternative installation: | KSM<br>left<br>(4-36)<br>4G0 407 253 B        | 1   |              |
| (19) | 4G0 407 253 B | wheel bearing housing<br>*no 'fi' function possible<br>see parts bulletin:<br>see workshop manual<br>alternative installation: | COBAPRESS<br>left<br>(4-36)<br>4G0 407 253 A  | 1   |              |
| (19) | 4G0 407 254 A | wheel bearing housing<br>*no 'fi' function possible<br>see parts bulletin:<br>see workshop manual<br>alternative installation: | KSM<br>right<br>(4-36)<br>4G0 407 254 B       | 1   |              |
| (19) | 4G0 407 254 B | wheel bearing housing<br>*no 'fi' function possible<br>see parts bulletin:<br>see workshop manual<br>alternative installation: | COBAPRESS<br>right<br>(4-36)<br>4G0 407 254 A | 1   |              |
| 20   | 4G0 407 689 C | swivel joint   | left a. right                                 | 2   |              |
| 21   | N 101 973 04  | hex collared bolt  | M10X65  | 2   |              |
| 22   | 8K0 407 613 B | wheel hub  |   | 2   |              |
| (22) | 8K0 407 607   | wheelhub with bearing  |   | 2   |              |
| 23   | 4H0 498 625 B | wheel bearing with assembly parts  |   | 2   |              |
| 24   | WHT 000 237 A | ball screw   | M12X1,5X45                                    | 8   |              |
| 25   | 8E0 407 643 A | socket head bolt with inner multipoint head  | M16X1,5X72                                    | 2   |              |
| 26   | 8K0 413 037 L | suspension forks   | left  | 1   |              |
| (26) | 8K0 413 038 L | suspension forks   | right   | 1   |              |
| 27   | N 104 213 04  | hexagon head bolt (combi)  | M12X1,5X80                                    | 2   |              |
| 28   | N 101 064 02  | hexagon collar nut self-locking  | M12X1,5<br>upper                              | 4   |              |
| (28) | WHT 003 684   | hex. nut, self-locking with washer   | M12X1,5<br>POS. 41                            | 2   |              |
| 29   | N 102 412 02  | hexagon bolt   | M12X1,5X85                                    | 2   |              |
| 30   | 8K0 411 317 D | coupling rod   | left a. right<br>170MM<br>not for:            | 2   | "RUS", "BY." |



# ETKA

|       |      |    |    |              |              |     |       |            |
|-------|------|----|----|--------------|--------------|-----|-------|------------|
| Model | Year | MG | SG | Illustration | Restrictions | UPD | 22:09 | 15.08.2013 |
| AQ5   | 2013 | 4  | 07 | 407-00       |              | 978 |       |            |

| Pos  | Part Number   | Description                                  | Remark  | Qty | Model        |
|------|---------------|--|---|-----|--------------|
| (30) | 4G0 411 317 A | coupling rod                                 | left a. right<br>170MM<br>also use:<br>>>D27.05.2013<br>4G0 411 317 A | 2   | "RUS", "BY." |
| 31   | N 106 999 01  | hexagon bolt                                 | M10X45  | 2   |              |
| 32   | N 105 707 02  | bolt,hex.hd.with shoul. (combi)              | AM10X60-TC  | 2   |              |
| 33   | N 102 861 10  | hexagon collar nut<br>self-locking           | M10   | 2   |              |
| 34   | 8R0 411 309 C | anti-roll bar                                | front   | 1   | quattro      |
| (34) | 8R0 411 309 D | anti-roll bar                                | front   | 1   | fr.wheel drv |
| 35   | 8K0 411 327 C | rubber bush                                  |   | 2   | quattro      |
| (35) | 4D0 411 327 H | rubber bush                                  |   | 2   | fr.wheel drv |
| 36   | 4D0 411 336 G | clamp  | front   | 2   |              |
| 37   | N 901 838 03  | hexagon collar nut<br>self-locking           | M8  | 4   |              |
| 38   |               | shock absorbers<br>see illustration:         | 411-00  | 2   | quattro      |
| (38) |               | shock absorbers<br>see illustration:         | 411-10  | 2   | fr.wheel drv |
| 39   |               | level sensor with poles<br>see illustration: | 941-25  | 2   |              |
| 40   |               | washer<br>included in position:              | 15  |     |              |
| 41   |               | washer<br>included in position:              | (28)  |     |              |