

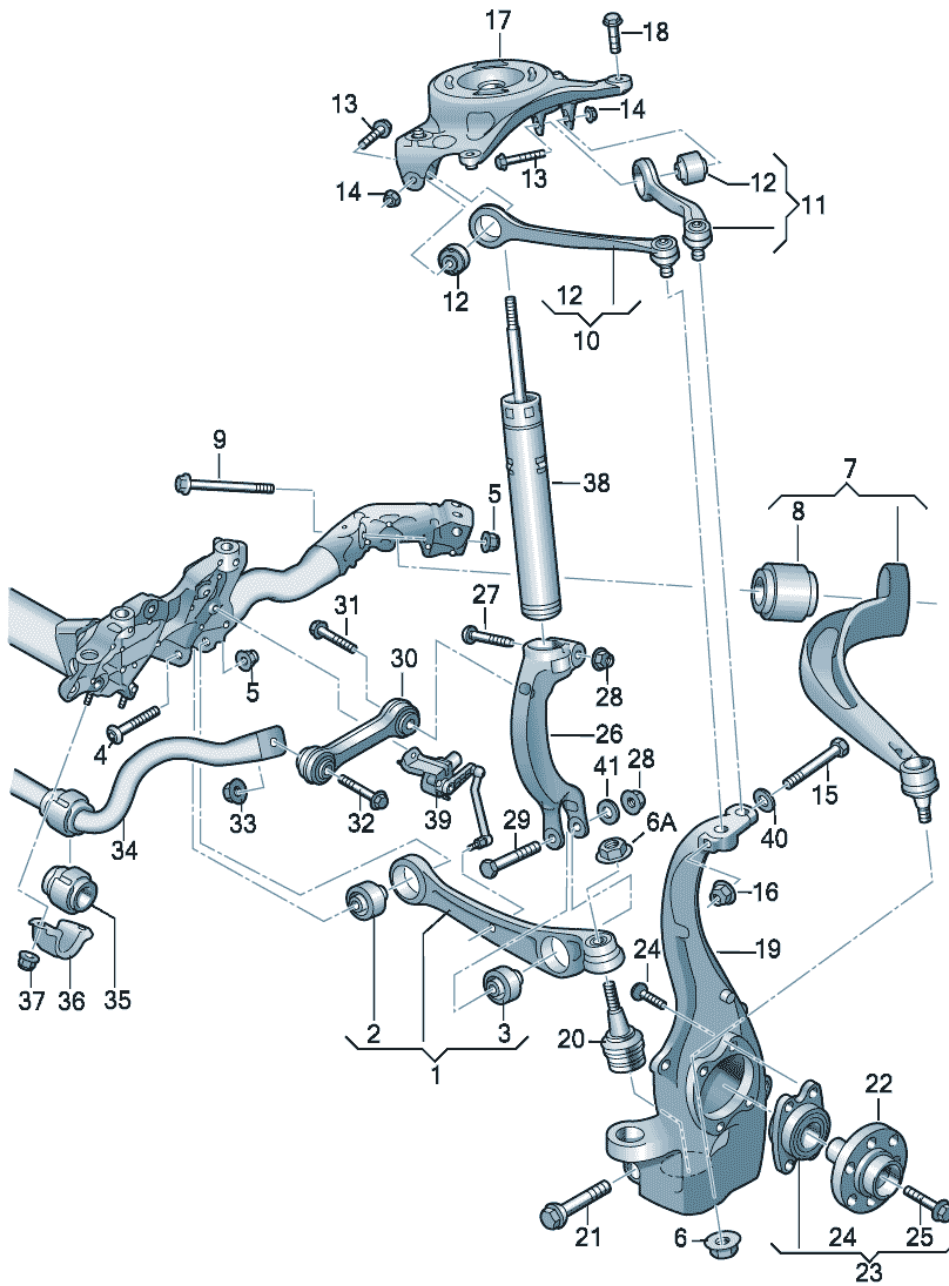

ETKA

Model	Year	MG	SG	Illustration	Restrictions	UPD	22:12	15.08.2013
AQ5	2013	4	07	407-05		978		





ETKA

Model	Year	MG	SG	Illustration	Restrictions	UPD	22:12	15.08.2013
AQ5	2013	4	07	407-05		978		

Pos	Part Number	Description	Remark	Qty	Model
		front wishbone link wheel bearing housing anti-roll bar	--SQ5--		CGQB
1	8K0 407 151 G	front wishbone link	left front	1	
(1)	8K0 407 152 G	front wishbone link	right front	1	
2	8K0 407 182 C	bonded rubber bush	inner	2	
3	4EO 407 181 B	bonded rubber bush	outer	2	
4	WHT 001 949	round hd. screw	M12X1,5X92	2	
5	WHT 001 987	hex. nut, self-locking with washer	M12X1,5	4	
6	WHT 006 151	hexagon collar nut self-locking	M14X1,5	2	
6A	WHT 006 151	hexagon collar nut self-locking	M14X1,5	2	
7	8R0 407 693	suspension guide	left front	1	
(7)	8R0 407 694	suspension guide	right front	1	
8	8K0 407 183 D	hydro-mounting	inner	2	
9	N 107 315 01	hex collared bolt	M12X1,5X118X90	2	
10	8K0 407 505 A	guide	left front upper	1	
(10)	8K0 407 506 A	guide	right front upper	1	
11	8K0 407 509 A	guide	left rear upper	1	
(11)	8K0 407 510 A	guide	right rear upper	1	
12	8R0 407 515	bonded rubber bush		4	
13	N 104 253 02	hex collared bolt	M10X62X45	4	
14	N 102 861 10	hexagon collar nut self-locking	M10	4	
15	N 107 709 01	hex collared bolt	CM10X110X24	2	
16	N 102 723 02	hexagon collar nut self-locking	M10	2	
17	8K0 412 391 F	bracket	left	1	
(17)	8K0 412 392 F	bracket	right	1	
18	N 911 523 01	hexagon head bolt (combi)	M10X35 S22	8	



ETKA

Model	Year	MG	SG	Illustration	Restrictions	UPD	22:12	15.08.2013
AQ5	2013	4	07	407-05		978		

Pos	Part Number	Description	Remark	Qty	Model
19	4G0 407 253 A	wheel bearing housing *no 'fi' function possible see parts bulletin: see workshop manual alternative installation:	KSM left (4-36) 4G0 407 253 B	1	
(19)	4G0 407 253 B	wheel bearing housing *no 'fi' function possible see parts bulletin: see workshop manual alternative installation:	COBAPRESS left (4-36) 4G0 407 253 A	1	
(19)	4G0 407 254 A	wheel bearing housing *no 'fi' function possible see parts bulletin: see workshop manual alternative installation:	KSM right (4-36) 4G0 407 254 B	1	
(19)	4G0 407 254 B	wheel bearing housing *no 'fi' function possible see parts bulletin: see workshop manual alternative installation:	COBAPRESS right (4-36) 4G0 407 254 A	1	
20	4G0 407 689 C	swivel joint	left a. right	2	
21	N 101 973 04	hex collared bolt	M10X65	2	
22	8K0 407 613 B	wheel hub		2	
(22)	8K0 407 607	wheelhub with bearing also use:	WHT 000 237 A 8E0 407 643 A	2	
23	4H0 498 625 B	wheel bearing with assembly parts		2	
24	WHT 000 237 A	ball screw	M12X1,5X45	8	
25	8E0 407 643 A	socket head bolt with inner multipoint head	M16X1,5X72	2	
26	8K0 413 037 L	suspension forks	left	1	
(26)	8K0 413 038 L	suspension forks	right	1	
27	N 104 213 04	hexagon head bolt (combi)	M12X1,5X80	2	
28	N 101 064 02	hexagon collar nut self-locking	M12X1,5 upper	2	
(28)	WHT 003 684	hex. nut, self-locking with washer	M12X1,5 POS. 41	2	
29	N 102 412 02	hexagon bolt	M12X1,5X85	2	
30	8K0 411 317 D	coupling rod	left a. right 170MM not for:	2	"RUS", "BY."



ETKA

Model	Year	MG	SG	Illustration	Restrictions	UPD	22:12	15.08.2013
AQ5	2013	4	07	407-05		978		

Pos	Part Number	Description	Remark	Qty	Model
(30)	4G0 411 317 A	coupling rod	left a. right 170MM also use: >>D27.05.2013 4G0 411 317 A	2	"RUS", "BY."
31	N 106 999 01	hexagon bolt	M10X45	2	
32	N 105 707 02	bolt,hex.hd.with shoul. (combi)	AM10X60-TC	2	
33	N 102 861 10	hexagon collar nut self-locking	M10	2	
34	8R0 411 309 C	anti-roll bar	front	1	
35	8K0 411 327 C	rubber bush		2	
36	4D0 411 336 G	clamp	front	2	
37	N 901 838 03	hexagon collar nut self-locking	M8	4	
38		shock absorbers see illustration:	411-05	2	
39		level sensor with poles see illustration:	941-25	2	
40		washer included in position:	15		
41		washer included in position:	(28)		