

Account

Vehicle

Help

Search

Contact

AutoZone Community

Exit

Your Vehicle: 2010 Audi Q7 Quattro (4LB) V6-3.0L DSL Turbo (CATA)



SAVE \$25  
instantly on 4 tires!

tirebuyer.com

SAVE NOW >

SAVE \$25  
instantly on 4 tires!

tirebuyer.com

SAVE NOW >

[Vehicle](#) » [Engine, Cooling and Exhaust](#) » [Engine](#) » [Fuel Filter](#) » [Service and Repair](#) » [Fuel Filter Overview, Vehicles With Vertical Fuel Filter](#)

## Fuel Filter Overview, Vehicles With Vertical Fuel Filter

### Fuel Filter Overview, Vehicles with Vertical Fuel Filter

Letting the high pressure pump run dry will destroy it.

- ⊗ It is necessary to bleed the fuel system before starting the engine for the first time if the fuel filter, fuel lines or the Auxiliary Fuel Pump (V393) were replaced on vehicles with engine code CATA through May 2010.

- Bleed the fuel system.

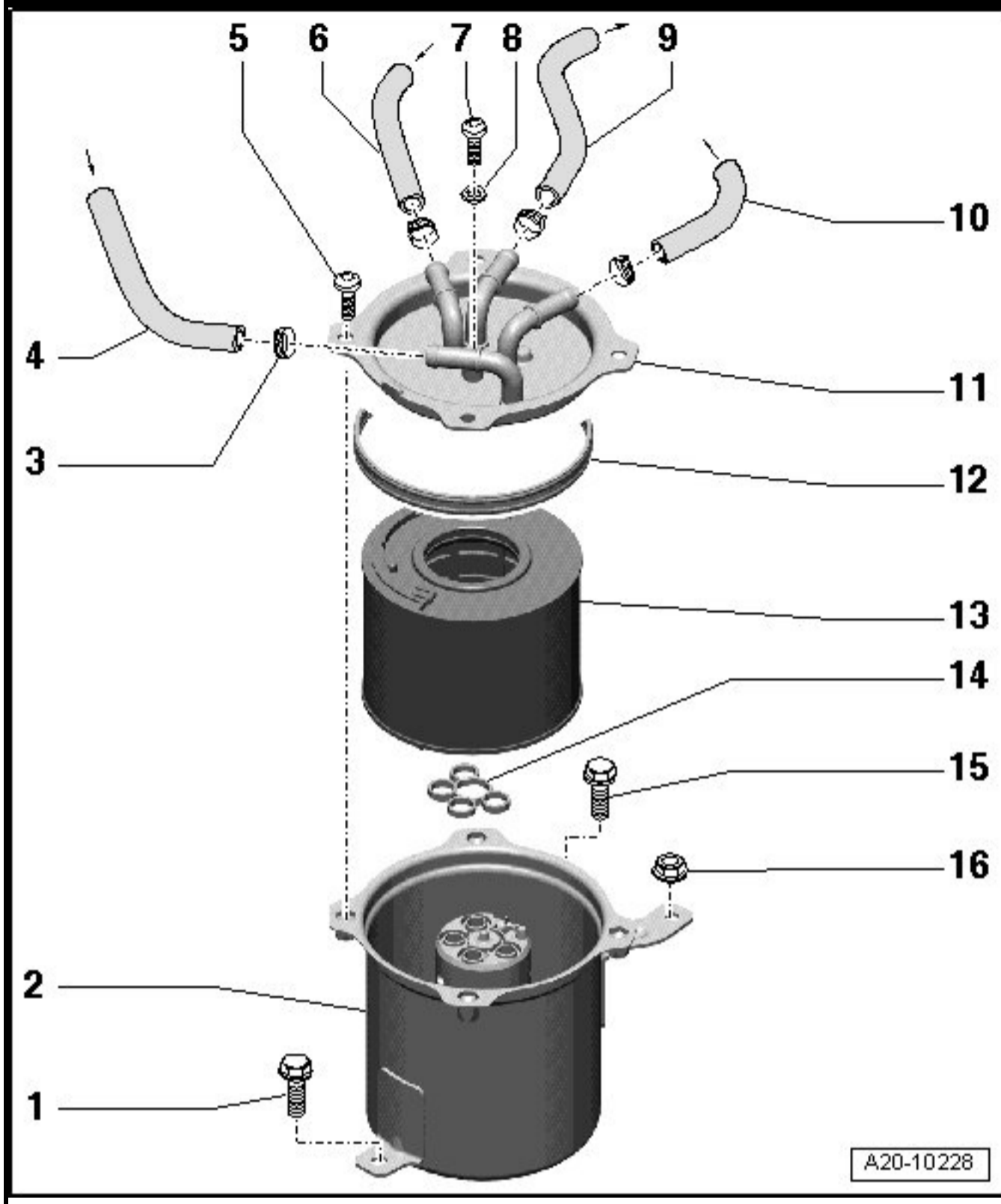

Zoom

Sized for Print

**1 Bolt**

⌘ 8 Nm

**2 Fuel Filter Housing**

⌘ Removing and installing, refer to => [ Fuel Filter, Vehicles with Vertical Fuel Filter ] [See: Fuel Filter, Vehicles With Vertical Fuel Filter](#)

**3 Spring-Type Clip**

**4 Fuel Supply Hose**

⌘ From the fuel tank

⌘ Connection identified by "VF" on the filter housing cover

**5 Bolt**

⌘ 8 Nm

## **6 Fuel Return Hose**

- ⌘ From engine
- ⌘ Connection identified by "RF" on the filter housing cover

## **7 Bleeder Screw**

- ⌘ 5 Nm

## **8 Seal**

- ⌘ Replace

## **9 Fuel Supply Hose**

- ⌘ To engine
- ⌘ Connection identified by "VM" on the filter housing cover

## **10 Fuel Return Hose**

- ⌘ To the fuel system cooler
- ⌘ Connection identified by "RT" on the filter housing cover

## **11 Filter Housing Cover**

- ⌘ Flow direction is identified
- ⌘ Do not interchange connections

## **12 Gasket**

- ⌘ Available as a replacement part only with - **13** -

## **13 Filter**

## **14 Gasket**

- ⌘ Available as a replacement part only with - **13** -

## **15 Bolt**

- ⌘ 8 Nm

## **16 Nut**

- ⌘ 8 Nm